

Front

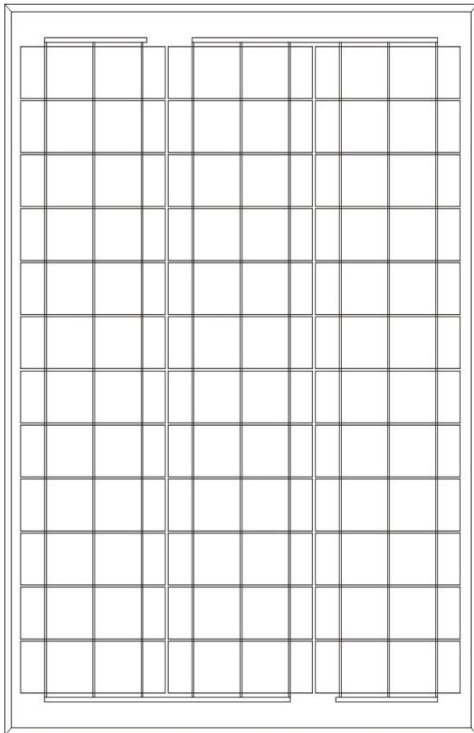

Rear

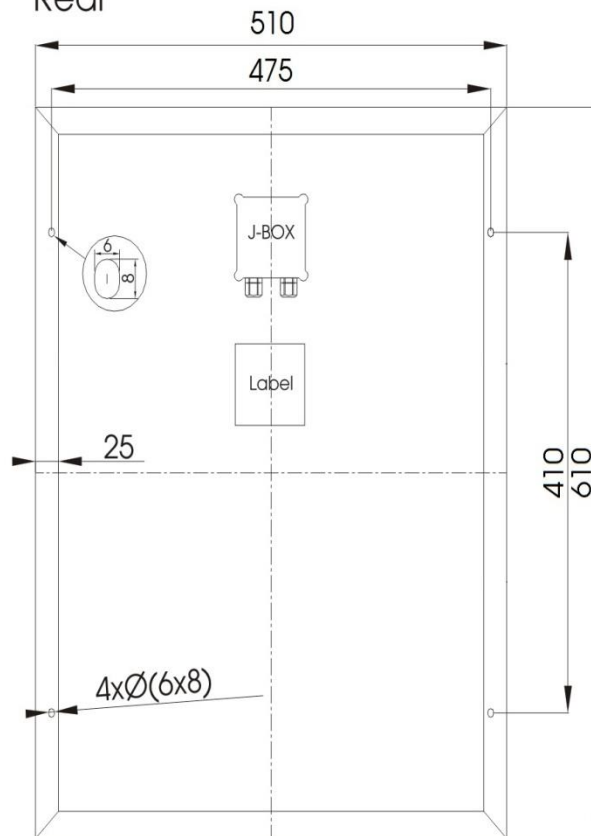

Section

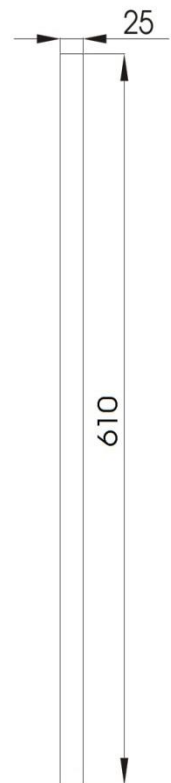

Dimensions:

(610 x 510) ± 2mm x 25 mm
Weight: 3.7 kg (NET)

Technical specification:

Laminate: Glass / EVA / TPE (tedlar / PET / tedlar) or TPT (white backsheet).
 Front: High-transmission 3.2 mm tempered glass
 Rear: TPT/TPE
 Cells: 36 multi-Si solar cells
 Frame: Clear anodized aluminium frame
 Output: Junction box, multicontact connectors (optional with cable)

Electrical data (at STC*): $P_{mpp}: 40 W^*$ (± 5 %) / $V_{mpp}: 18 V^*$ / $I_{mpp}: 2.22 A^*$ / $V_{oc}: 22.3 V^*$ / $I_{sc}: 2.42 A^*$

*: Standard Test Conditions (1000W/m², 25°C, 1.5 AM).

SOLARC Innovative Solarprodukte GmbH Glogauer Straße 21, D-10999 Berlin Tel/Fax 030-3198554-00/99 info@solarc.de www.solarc.de	Product / Project CSM 36.4000 / Standard	Document Tech. Data Sheet	Issued 11.08.2011	Author AN
	Comments Data subject to change	Document no./ Ref. - / -	Modified	Author